

# Toyota C-HR 1.2 T

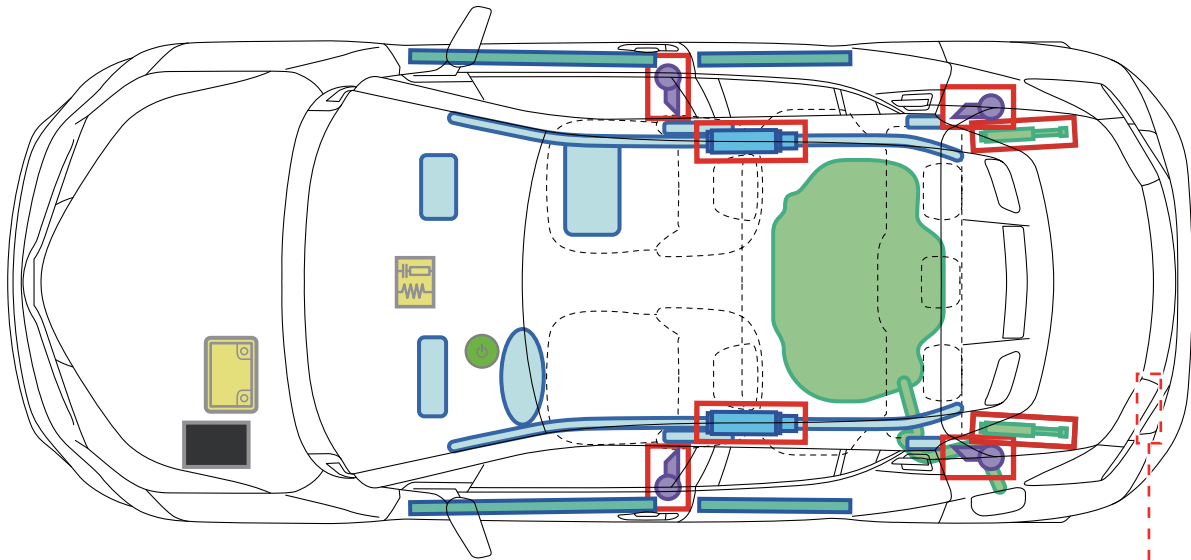







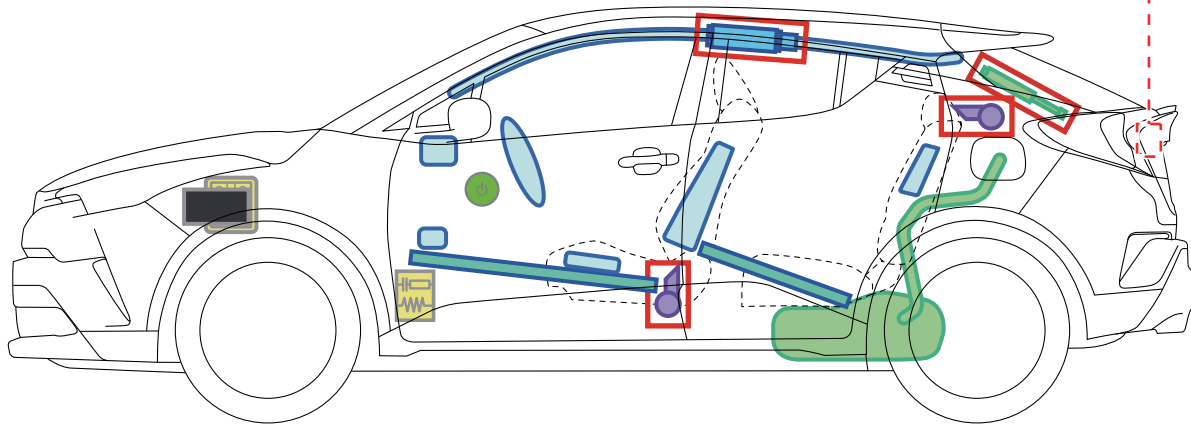

AX1T (EU,M)

ab 10.2016



*C-HR*



	<b>Zündschalter</b>		<b>Sicherungskasten</b>		<b>12V Batterie</b>
	<b>Airbag</b>		<b>Gasgenerator</b>		<b>Kraftstofftank</b>
	<b>Gasdruckdämpfer</b>		<b>Gurtstraffer</b>		<b>Karosserieverstärkung</b>
	<b>Steuergerät</b>	-	-	-	-
-	-	-	-	-	-

### Fahrzeug ausser Betrieb setzen

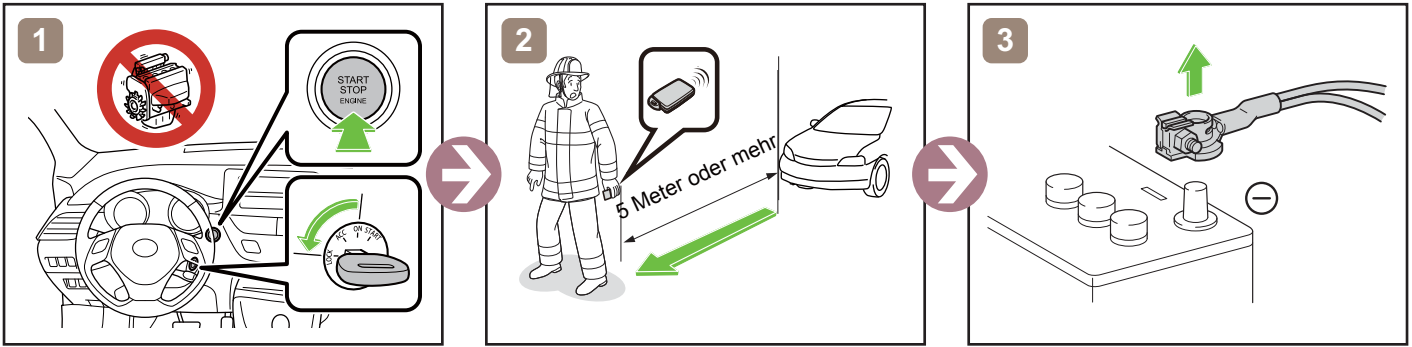

oder

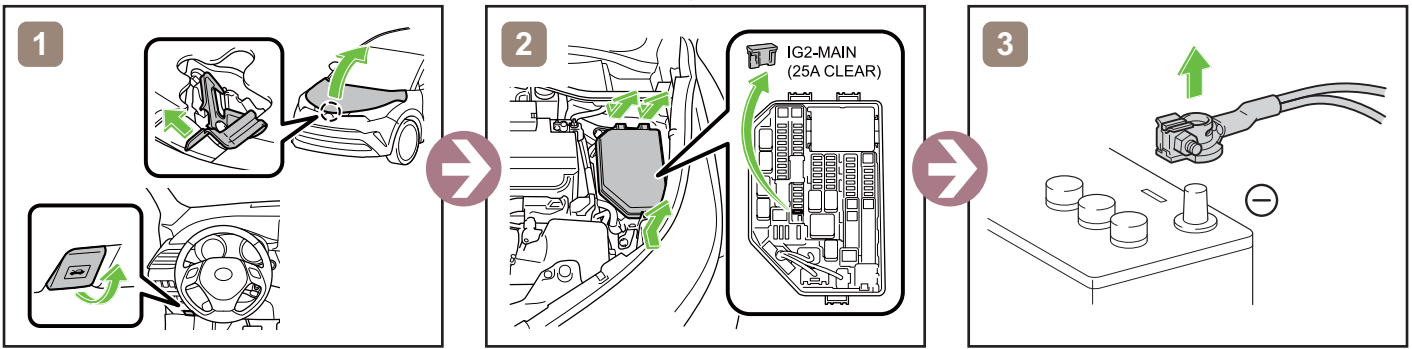

### Zugang 12V-Batterie

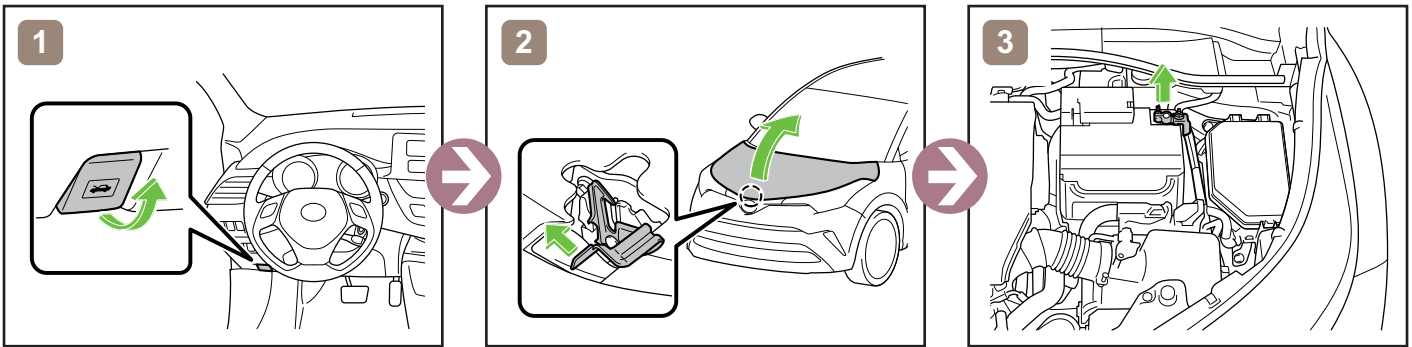

### Hinweise zum Transport

