

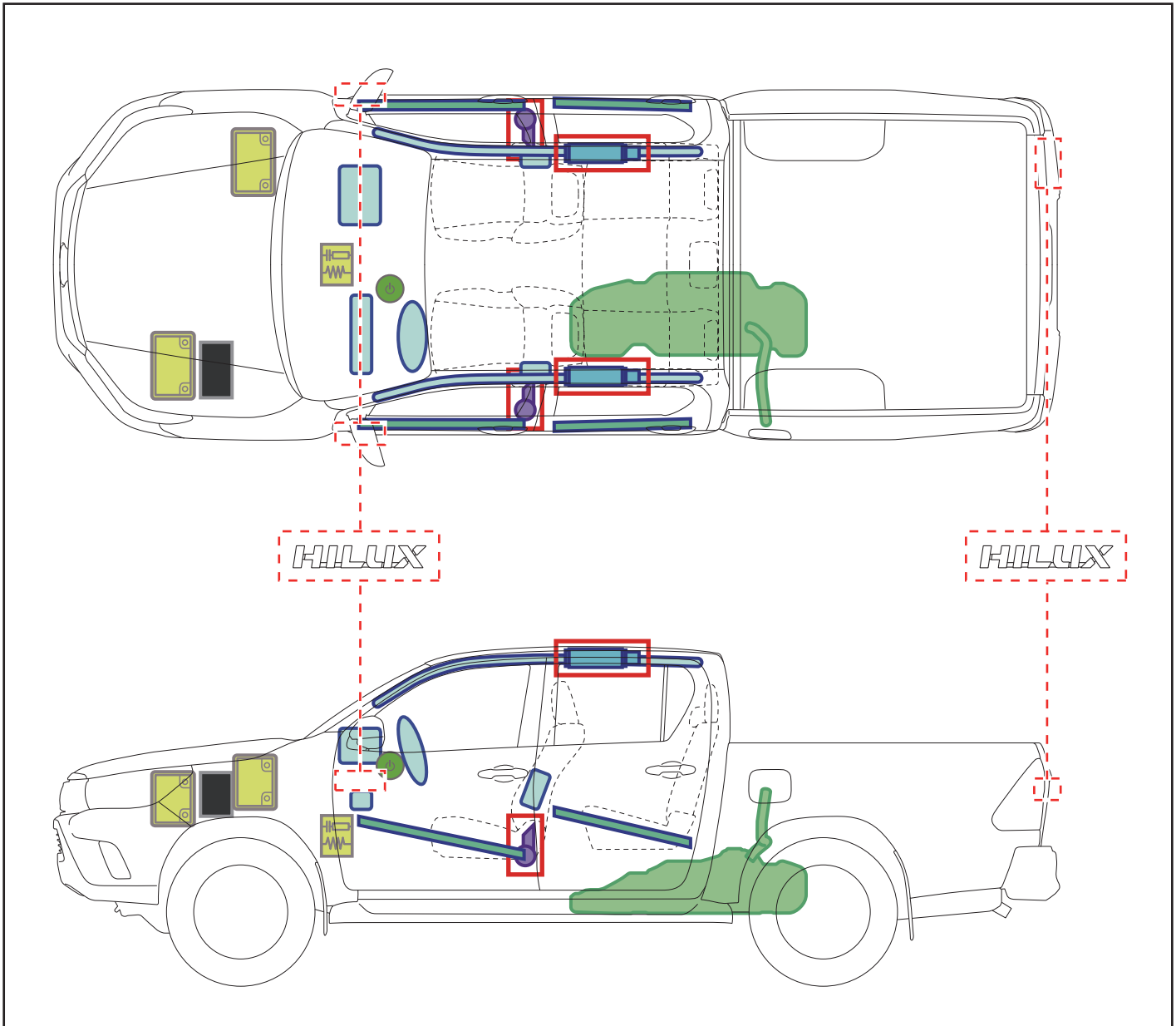









HILUX
DOUBLE CAB
AN1P (EU,N)
06.2015



	Zündschalter		Sicherungskasten		12V Batterie
	Airbag		Gasgenerator		Kraftstofftank
	Gurtstraffer		Karosserieverstärkung		Steuergerät
—	—	—	—	—	—
—	—	—	—	—	—

Fahrzeug ausser Betrieb setzen

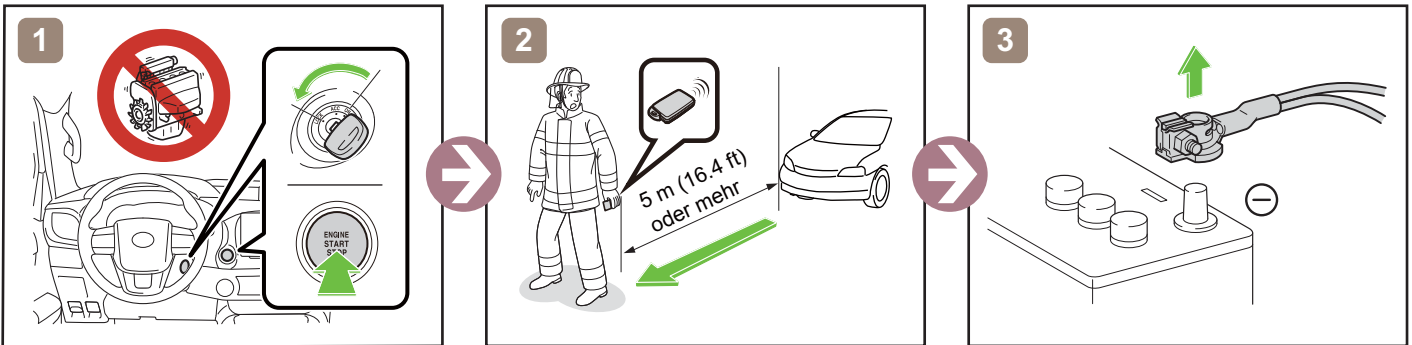

oder

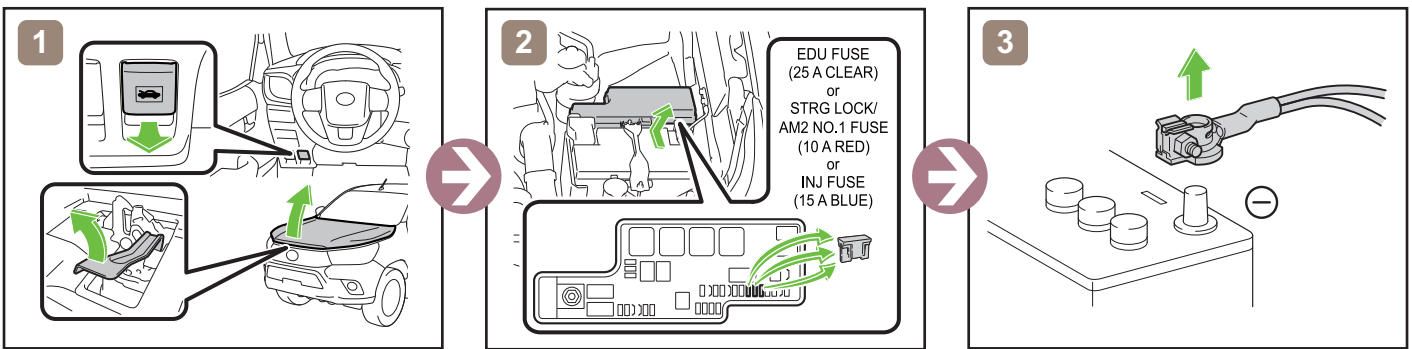

Zugang 12V-Batterie

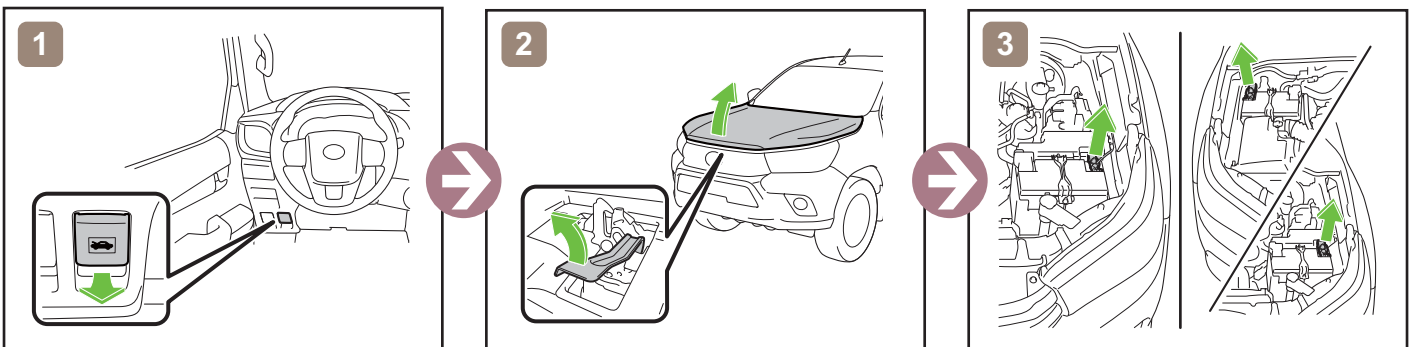

Hinweise zum Transport

